

2 4 6 8 10m 20 30 40 50 60 80 100

NOTES:
 Building Records drawings remain the property of the University of South Australia and must be returned upon request.
 These drawings may be inaccurate, and are subject to change without notice. Any errors and/or omissions should be reported to the Facilities Management Unit.

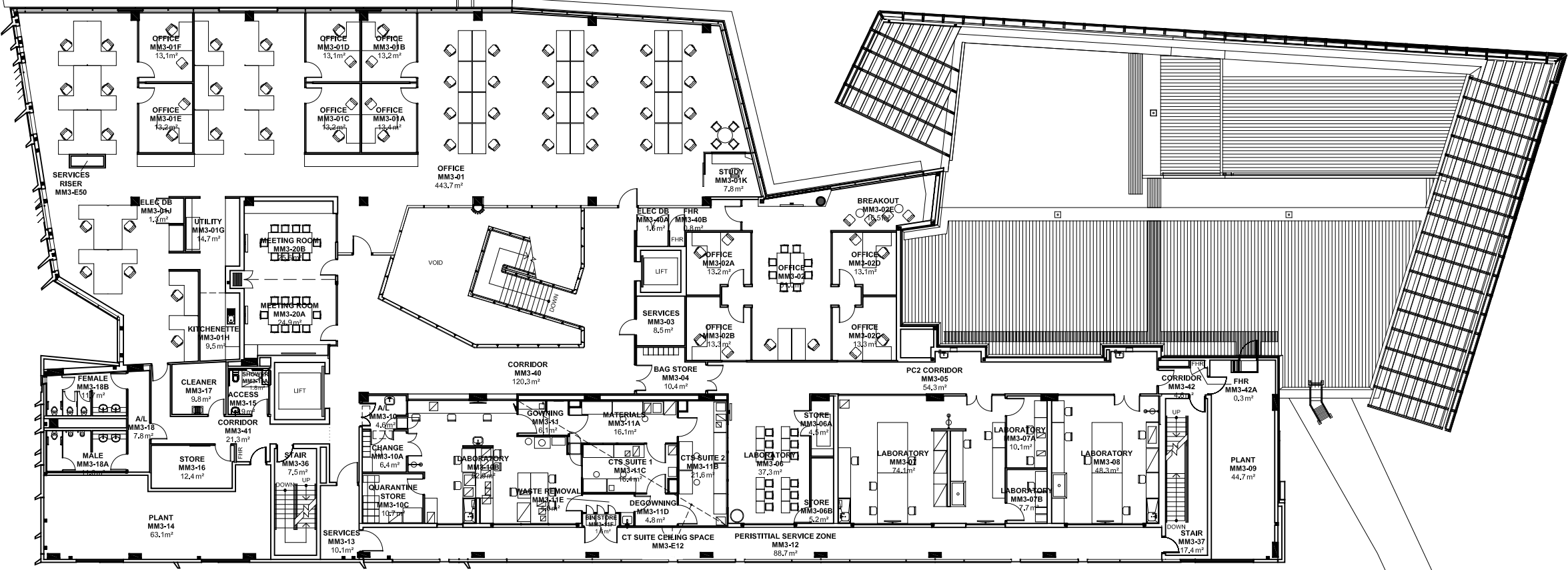

UNIVERSITY OF SOUTH AUSTRALIA

FACILITIES MANAGEMENT UNIT
 101 Currie Street,
 Adelaide, SA 5000
 Phone 8302 2762
 Fax 8302 2708

**BUILDING RECORDS
 MAWSON LAKES CAMPUS**

Building
**MATERIALS and MINERALS
 SCIENCE - BUILDING MM
 LEVEL 3**

Scale: Refer to scale bar
 Drawn: J Hvalica

Last Update:
 26/11/2019

Drawing No.: **A558PL03 - W**
 Revision: **F**