

1 2 3 4 5m 10 20 30

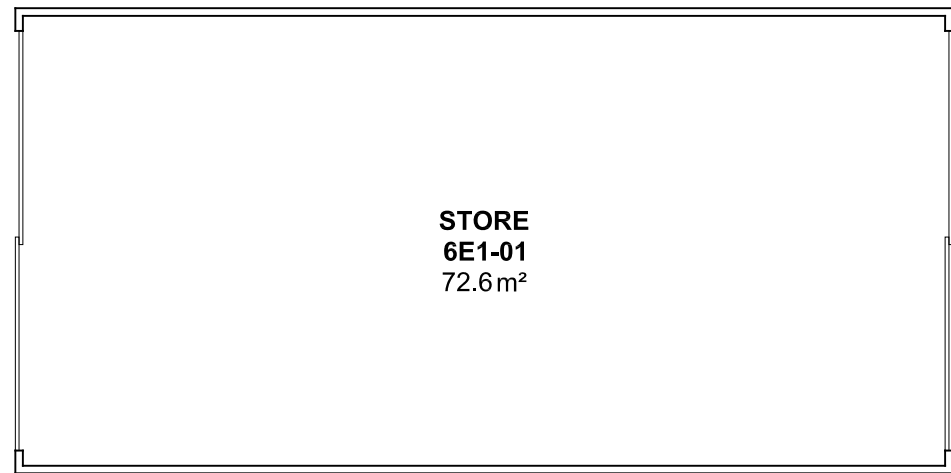

SHED 6D



STORE
6E1-01
72.6m²

NOTES:
Building Records drawings remain the property of the University of South Australia and must be returned upon request.
These drawings may be inaccurate, and are subject to change without notice. Any errors and/or omissions should be reported to the Facilities Management Unit.



UNIVERSITY OF
SOUTH AUSTRALIA

**FACILITIES
MANAGEMENT
UNIT**
101 Currie Street,
Adelaide, SA 5000
Phone 8302 2762
Fax 8302 2708

**BUILDING RECORDS
WHYALLA CAMPUS**

Building

**SHED 6E
LEVEL 01**

Scale: Refer to scale bar
Drawn: J Hvalica

Last Update:
12/09/2016

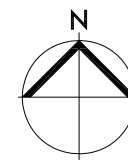

Drawing No.: **A6EPL01 - W**
Revision: **A**