

5 10m 25 50 75

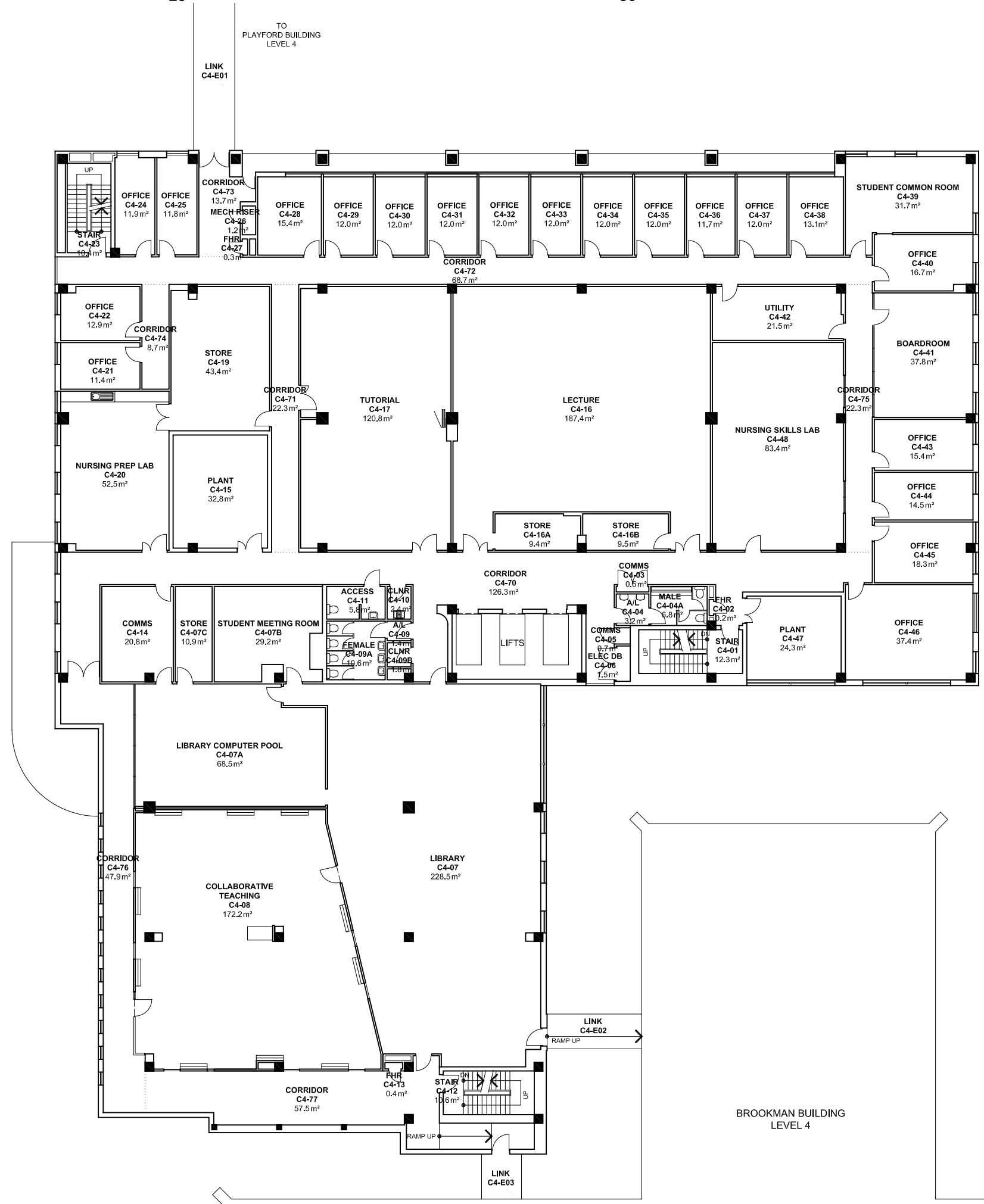

**NOTES:**  
 Building Records drawings remain the property of the University of South Australia and must be returned upon request.  
 These drawings may be inaccurate, and are subject to change without notice. Any errors and/or omissions should be reported to the Facilities Management Unit.



UNIVERSITY OF SOUTH AUSTRALIA

FACILITIES MANAGEMENT UNIT  
 101 Currie Street, Adelaide, SA 5000

BUILDING RECORDS  
 CITY EAST CAMPUS

Building  
 CENTENARY BUILDING C  
 LEVEL 4

Scale: Refer to scale bar  
 Drawn: J Hvalica  
 Last Update: 01/06/2022

Drawing No.: A104PL04 - W  
 Revision: Q

