

1 2 3 4 5m 10 20 30

NOTES:
 Building Records drawings remain the property of the University of South Australia and must be returned upon request.
 These drawings may be inaccurate, and are subject to change without notice. Any errors and/or omissions should be reported to the Facilities Management Unit.

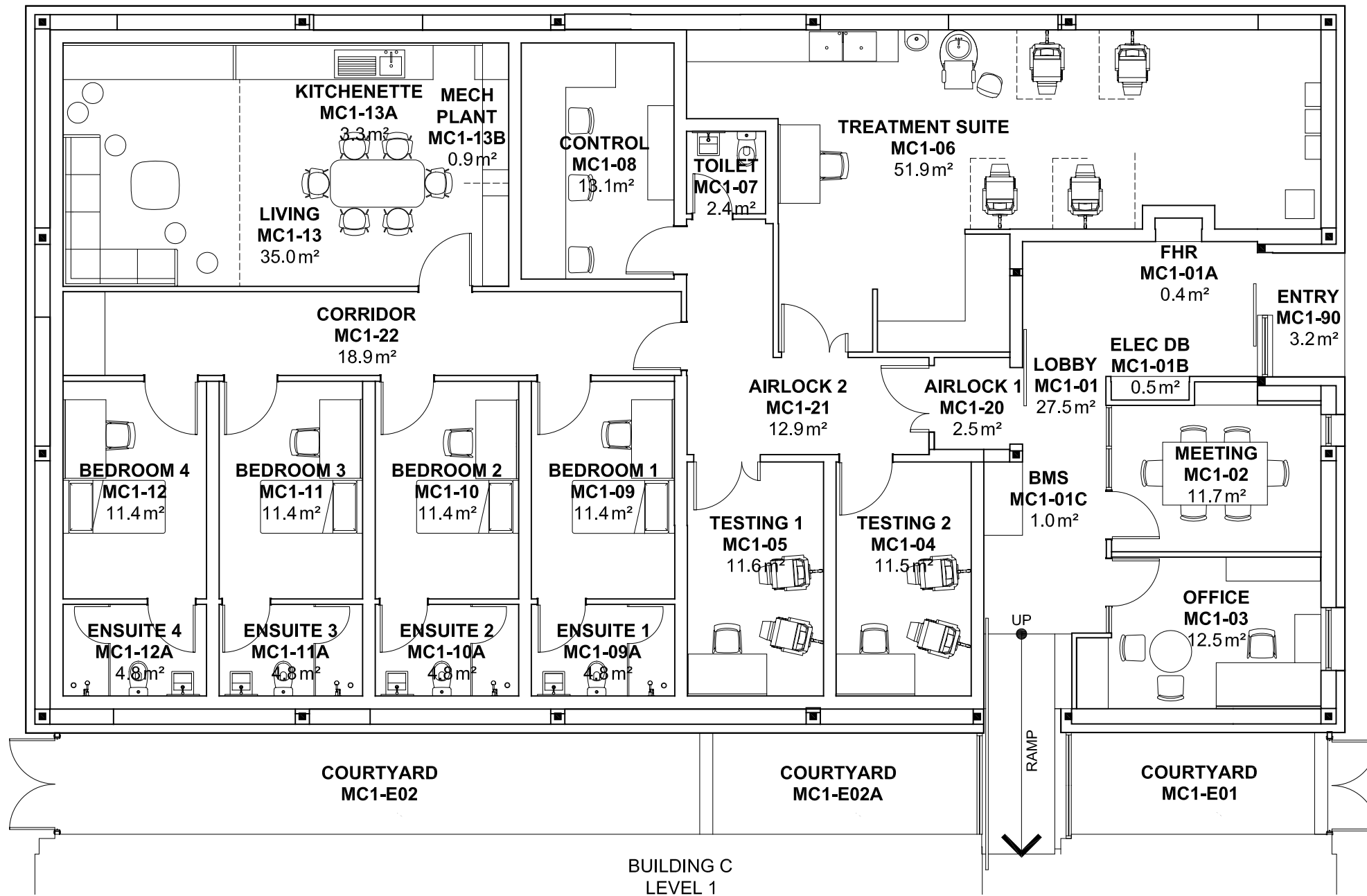

BUILDING C
LEVEL 1



UNIVERSITY OF
SOUTH AUSTRALIA

FACILITIES
MANAGEMENT
UNIT

101 Currie Street,
Adelaide, SA 5000
Phone 8302 2762
Fax 8302 2708

BUILDING RECORDS
MAGILL CAMPUS

Building

BUILDING MC
LEVEL 1

Scale:
Refer to scale bar

Drawn:
J Hvalica

Last Update:
28/06/2017

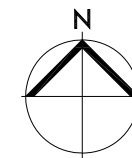

Drawing No.:
A319PL01 - W

Revision:
F