

2 4 6 8 10m 20 40 60

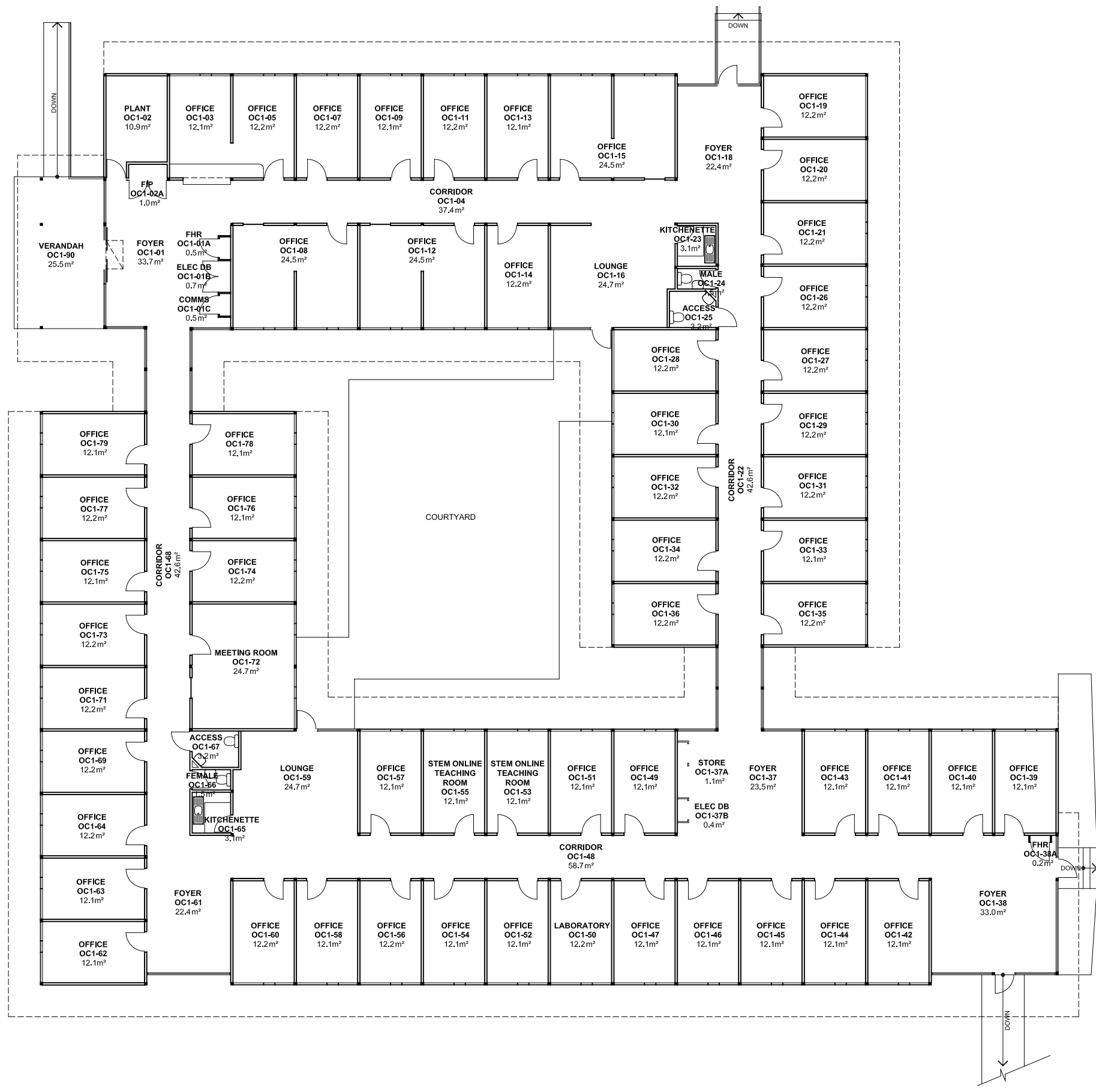

**NOTES:**  
 Building Records drawings remain the property of the University of South Australia and must be returned upon request.  
 These drawings may be inaccurate, and are subject to change without notice. Any errors and/or omissions should be reported to the Facilities Management Unit.



**UNIVERSITY OF SOUTH AUSTRALIA**

**FACILITIES MANAGEMENT UNIT**  
 101 Currie Street, Adelaide, SA 5000

**BUILDING RECORDS MAWSON LAKES CAMPUS**

Building  
**BUILDING OC LEVEL 1**

Scale: Refer to scale bar  
 Drawn: J Hvalica  
 Last Update: 24/05/2022

Drawing No.: **A529PL01 - W**  
 Revision: **T**

