

5 10m 25 50 75

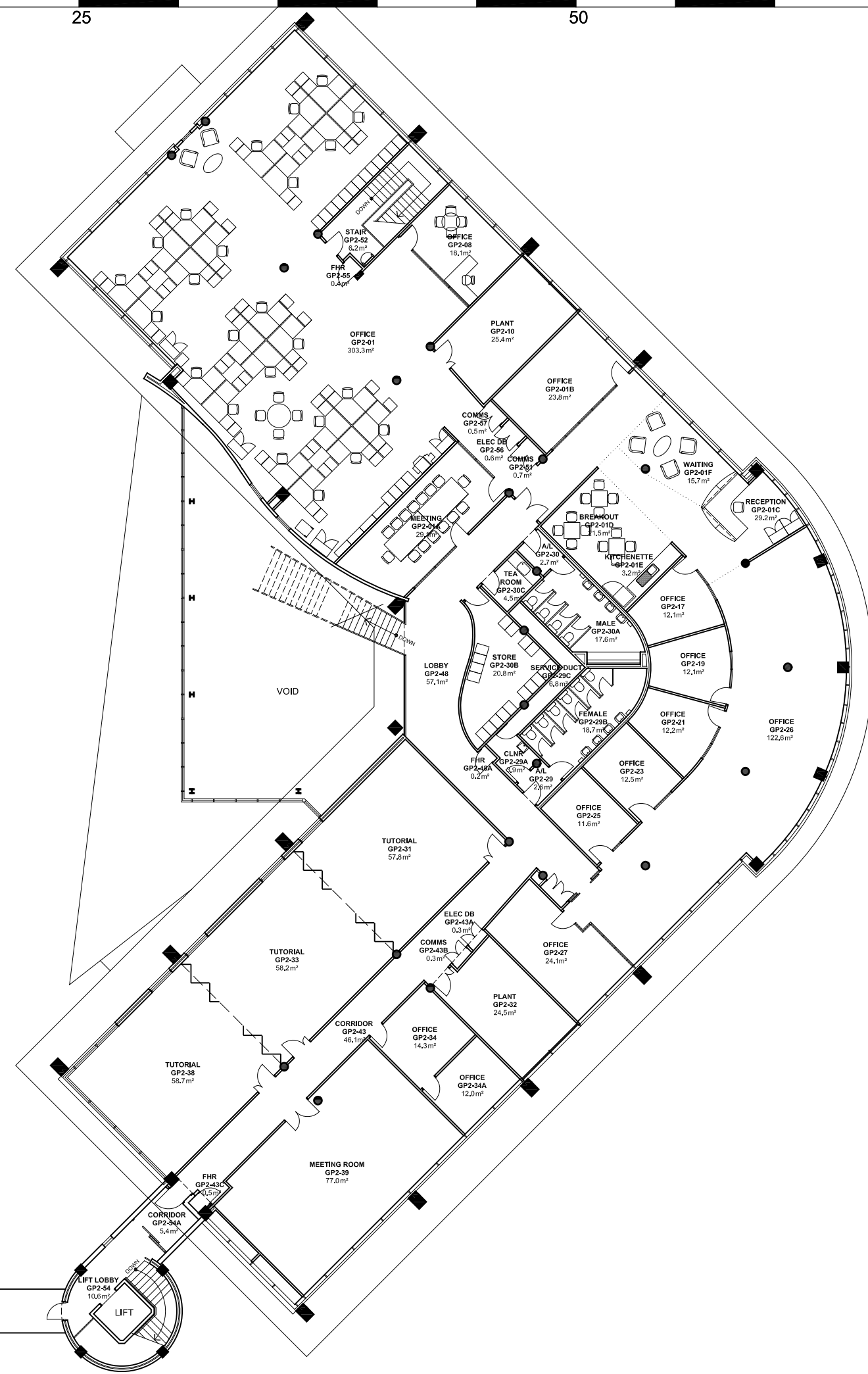

**NOTES:**  
Building Records drawings remain the property of the University of South Australia and must be returned upon request.  
These drawings may be inaccurate, and are subject to change without notice. Any errors and/or omissions should be reported to the Facilities Management Unit.



**UNIVERSITY OF SOUTH AUSTRALIA**

**FACILITIES MANAGEMENT UNIT**  
101 Currie Street,  
Adelaide, SA 5000  
Phone 8302 2762  
Fax 8302 2708

**BUILDING RECORDS  
MAWSON LAKES CAMPUS**

Building  
**BUILDING GP  
LEVEL 2**

Scale: Refer to scale bar  
Last Update: 23/08/2018  
Drawn: J Hvalica

Drawing No.: **A537PL02 - W**  
Revision: **Q**

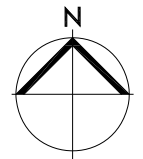

BUILDING A  
LEVEL 2