

1 2 3 4 5m 10 20 30

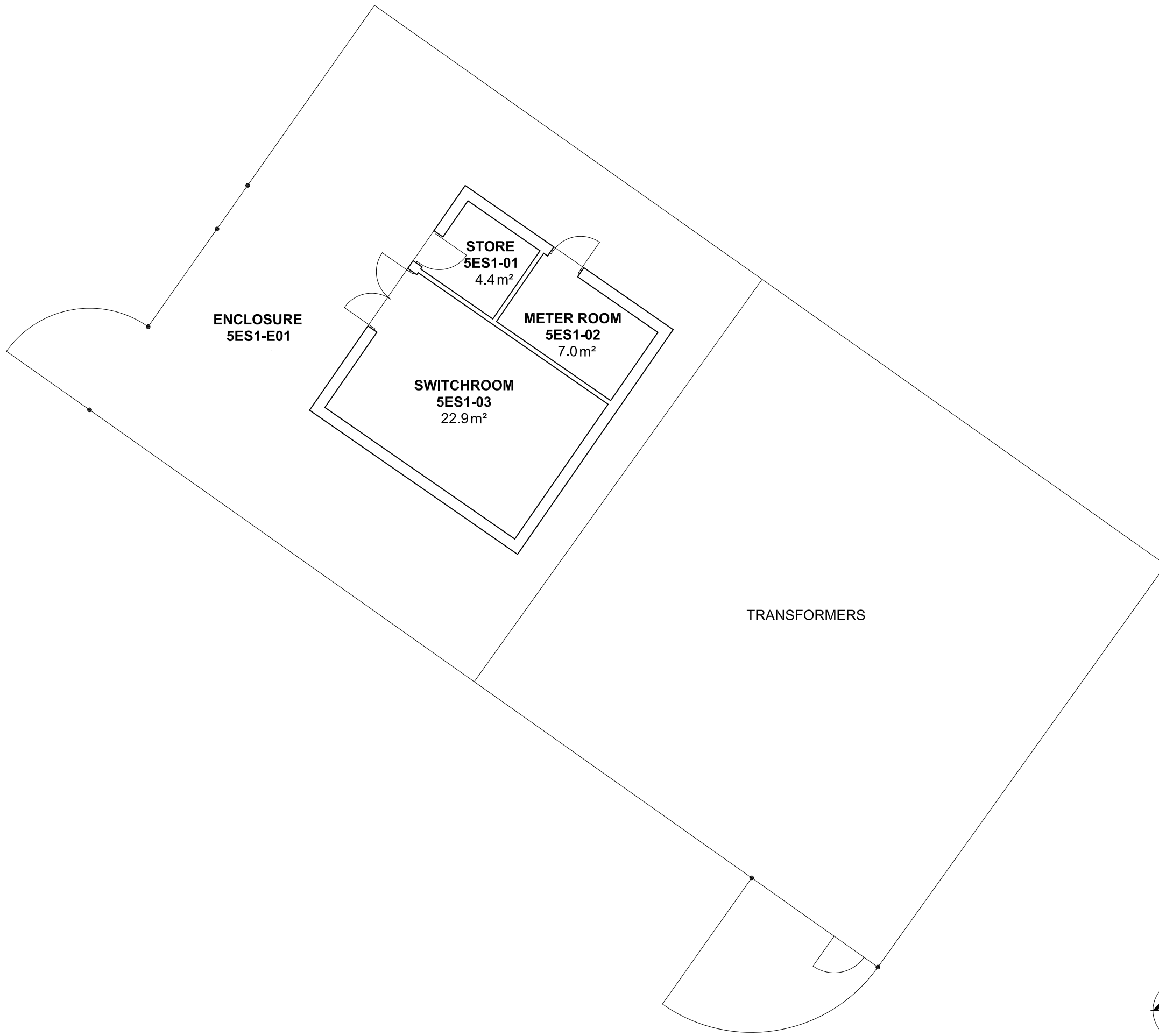

**NOTES:**  
 Building Records drawings remain the property of the University of South Australia and must be returned upon request.  
 These drawings may be inaccurate, and are subject to change without notice. Any errors and/or omissions should be reported to the Facilities Management Unit.



**UNIVERSITY OF SOUTH AUSTRALIA**

**FACILITIES MANAGEMENT UNIT**  
 101 Currie Street,  
 Adelaide, SA 5000  
 Phone 8302 2762  
 Fax 8302 2708

**BUILDING RECORDS  
 MAWSON LAKES CAMPUS**

Building  
**ETSA SUBSTATION - 5ES  
 LEVEL 01**

Scale: Refer to scale bar  
 Drawn: J Hvalica  
 Last Update: 08/09/2016

Drawing No.: **A5ESPL01 - W**  
 Revision: **A**

